

## FLT Track System

Magnetic Low voltage Track System

High Quality, Low Voltage  
Slim-Profile Magnetic Track System



- Magnetic system for easy installation and adjustment
- Safe Low Voltage 24V DC
- Surface, Recessed and Pendant mount track available
- Double Joint Spot and Double-sided track available(up and down)
- Black and White Finishes
- Various light fixtures and beam angle





FLT Track System - Spot



Photometric data

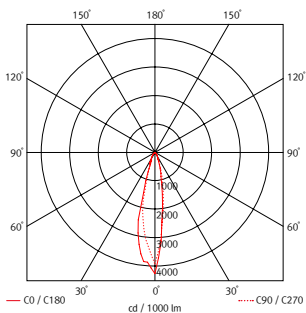

Specification

Model Name	Power Input	Lamp Power	Lumens (3000K)	Efficiency (3000K)	Color Rendering	Available color	Beam Angle	Operating Temperature
FLT-SS06 30K-24V	DC 24V	6.3 W	438.1 lm	69.7 lm/W	Ra > 90	2,700K/3,000K/3,500K/4,000K	15° / 24° / 36°	0 ~ 45℃

\* FLT-SS06 Double Joint available

Dimension

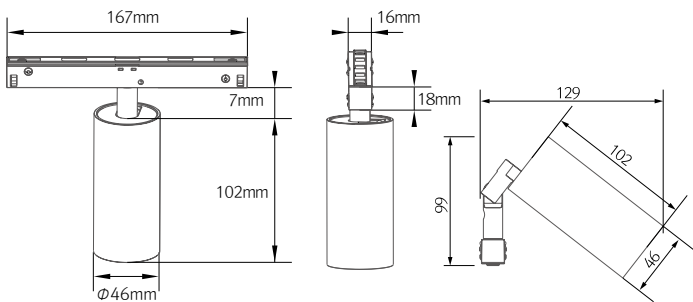

Model Name	A (mm)	B (mm)	C (mm)	D (mm)	E (mm)	F (mm)
FLT-SS06 30K-24V	46	167	7	102	16	18

Beam angle	Black	White
15°	FLT-SS06 30K-24V-BK-15	FLT-SS06 30K-24V-WT-15
24°	FLT-SS06 30K-24V-BK-24	FLT-SS06 30K-24V-WT-24
36°	FLT-SS06 30K-24V-BK-36	FLT-SS06 30K-24V-WT-36



Photometric data

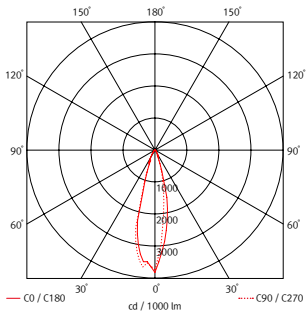

Specification

Model Name	Power Input	Lamp Power	Lumens (3000K)	Efficiency (3000K)	Color Rendering	Available color	Beam Angle	Operating Temperature
FLT-SS09 35K-24V	DC 24V	8.9 W	783 lm	88.5 lm/W	Ra > 90	2,700K/3,000K/3,500K/4,000K	15° / 24° / 36°	0 ~ 45℃

\* FLT-SS09 Double Joint available

Dimension

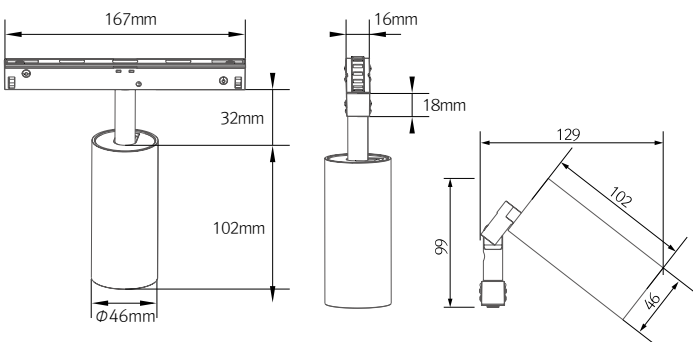

Model Name	A (mm)	B (mm)	C (mm)	D (mm)	E (mm)	F (mm)
FLT-SS09 35K-24V	46	167	32	102	16	18

Beam angle	Black	White
15°	FLT-SS09 35K-24V-BK-15	FLT-SS09 35K-24V-WT-15
24°	FLT-SS09 35K-24V-BK-24	FLT-SS09 35K-24V-WT-24
36°	FLT-SS09 35K-24V-BK-36	FLT-SS09 35K-24V-WT-36



Photometric data

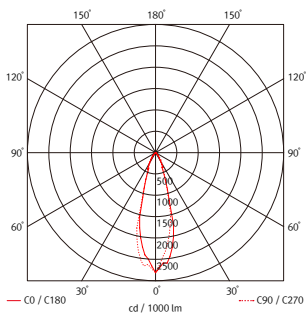

Specification

Model Name	Power Input	Lamp Power	Lumens (3000K)	Efficiency (3000K)	Color Rendering	Available color	Beam Angle	Operating Temperature
FLT-SS15 30K-24V	DC 24V	14.75 W	1068.8 lm	72.41 lm/W	Ra > 90	2,700K/3,000K/3,500K/4,000K	15° / 24° / 36°	0 ~ 45℃

\* FLT-SS15 Double Joint available

Dimension

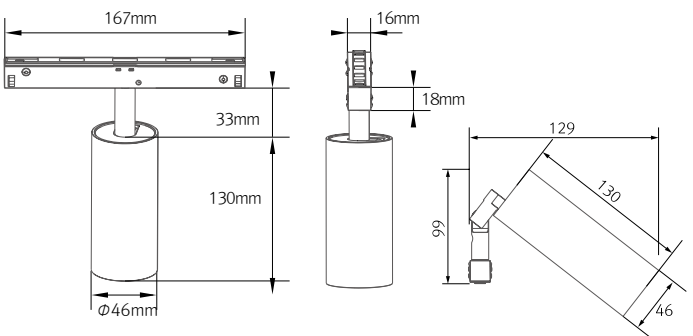

Model Name	A (mm)	B (mm)	C (mm)	D (mm)	E (mm)	F (mm)
FLT-SS15 30K-24V	46	167	33	130	16	18

Beam angle	Black	White
15°	FLT-SS15 30K-24V-BK-15	FLT-SS15 30K-24V-WT-15
24°	FLT-SS15 30K-24V-BK-24	FLT-SS15 30K-24V-WT-24
36°	FLT-SS15 30K-24V-BK-36	FLT-SS15 30K-24V-WT-36



Photometric data

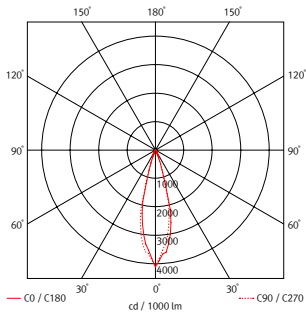

Specification

Model Name	Power Input	Lamp Power	Lumens (3000K)	Efficiency (3000K)	Color Rendering	Available color	Beam Angle	Operating Temperature
FLT-SS20 30K-24V	DC 24V	19 W	1,368 lm	74.9 lm/W	Ra > 90	2,700K/3,000K/3,500K/4,000K	15° / 24° / 36°	0 ~ 45℃

\* FLT-SS20 Double Joint available

Dimension

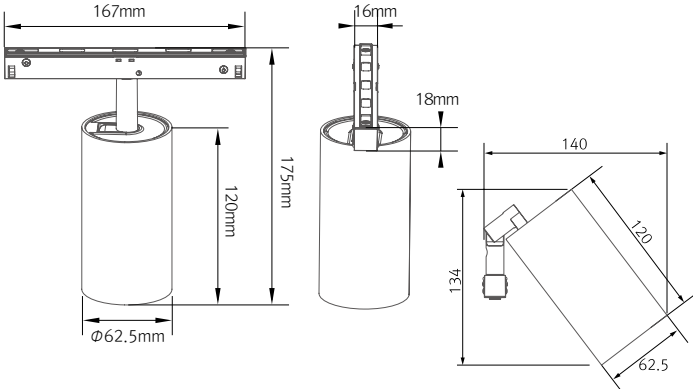

Model Name	A (mm)	B (mm)	C (mm)	D (mm)	E (mm)	F (mm)
FLT-SS20 30K-24V	62.5	167	120	154	16	18

Beam angle	Black	White
15°	FLT-SS20 30K-24V-BK-15	FLT-SS20 30K-24V-WT-15
24°	FLT-SS20 30K-24V-BK-24	FLT-SS20 30K-24V-WT-24
36°	FLT-SS20 30K-24V-BK-36	FLT-SS20 30K-24V-WT-36



#### Photometric data

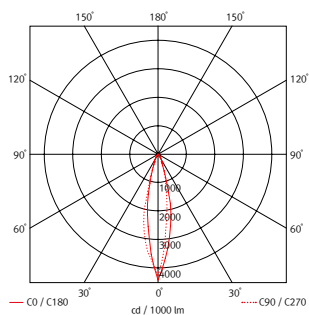

#### Specification

Model Name	Power Input	Lamp Power	Lumens (3000K)	Efficiency (3000K)	Color Rendering	Available color	Beam Angle	Operating Temperature
FLT-SL06 30K-24V	DC 24V	6.3 W	435 lm	68.9 lm/W	Ra > 90	2,700K/3,000K/3,500K/4,000K	15°/24°/36°	0~45℃

#### Dimension

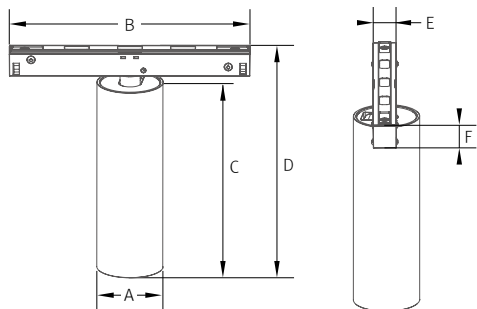

Model Name	A (mm)	B (mm)	C (mm)	D (mm)	E (mm)	F (mm)
FLT-SL06 30K-24V	46	167	200	226	16	18

Beam angle	Black	White
15°	FLT-SL06 30K-24V-BK-15	FLT-SL06 30K-24V-WT-15
24°	FLT-SL06 30K-24V-BK-24	FLT-SL06 30K-24V-WT-24
36°	FLT-SL06 30K-24V-BK-36	FLT-SL06 30K-24V-WT-36



#### Photometric data

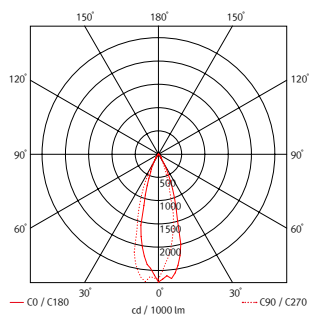

#### Specification

Model Name	Power Input	Lamp Power	Lumens (3000K)	Efficiency (3000K)	Color Rendering	Available color	Beam Angle	Operating Temperature
FLT-SM12 30K-24V	DC 24V	12 W	1025 lm	85.4 lm/W	Ra > 90	2,700K/3,000K/3,500K/4,000K	15°/24°/36°	0~45℃

#### Dimension

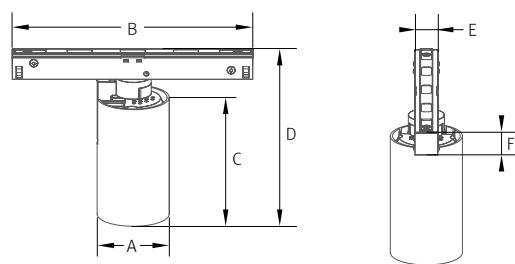

Model Name	A (mm)	B (mm)	C (mm)	D (mm)	E (mm)	F (mm)
FLT-SM12 40K-24V	50	167	86	120	16	18

Beam angle	Black	White
15°	FLT-SM12 30K-24V-BK-15	FLT-SM12 30K-24V-WT-15
24°	FLT-SM12 30K-24V-BK-24	FLT-SM12 30K-24V-WT-24
36°	FLT-SM12 30K-24V-BK-36	FLT-SM12 30K-24V-WT-36

## FLT Track System - Stix



#### Photometric data

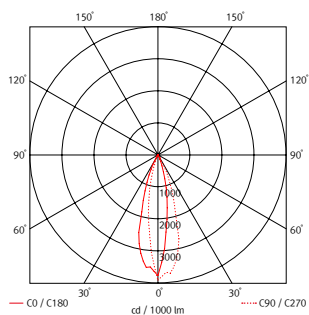

#### Specification

Model Name	Power Input	Lamp Power	Lumens (3000K)	Efficiency (3000K)	Color Rendering	Available color	Beam Angle	Operating Temperature
FLT-SM02 30K-24V	DC 24V	1.7 W	98 lm	58.6 lm/W	Ra > 90	2,700K/3,000K/3,500K/4,000K	15°/24°/36°	0~45℃

#### Dimension

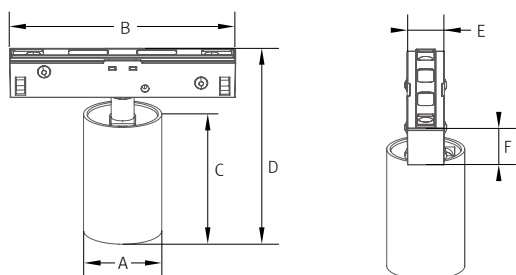

Model Name	A (mm)	B (mm)	C (mm)	D (mm)	E (mm)	F (mm)
FLT-SM02 30K-24V	34	98	56.5	85	16	16

Beam angle	Black	White
15°	FLT-SM02 30K-24V-BK-15	FLT-SM02 30K-24V-WT-15
24°	FLT-SM02 30K-24V-BK-24	FLT-SM02 30K-24V-WT-24
36°	FLT-SM02 30K-24V-BK-36	FLT-SM02 30K-24V-WT-36



#### Photometric data

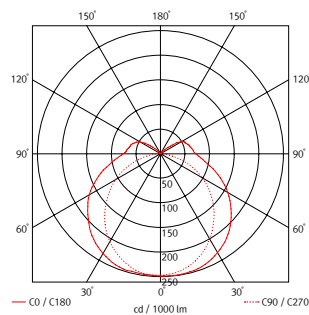

#### Specification

Model Name	Power Input	Lamp Power	Lumens (3000K)	Efficiency (3000K)	Color Rendering	Available color	Operating Temperature
FLT-LM30 30K-24V	DC 24V	10.3 W	787.5 lm	76.5 lm/W	Ra > 90	2,700K/3,000K/3,500K/4,000K	0~45℃

#### Dimension

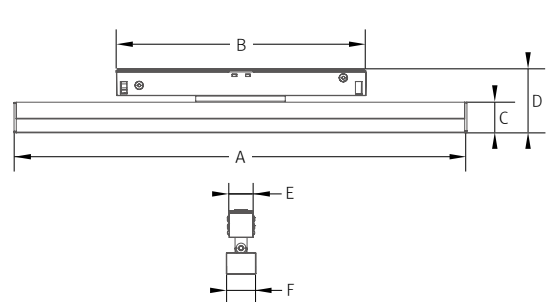

Model Name	A (mm)	B (mm)	C (mm)	D (mm)	E (mm)	F (mm)
FLT-LM30 30K-24V	303	167	20.5	43	16	20.5



### Specification

Model Name	Power Input	Lamp Power	Lumens (3000K)	Efficiency (3000K)	Color Rendering	Available color	Beam Angle	Weight of Luminaire	Operating Temperature
FLT-LS10 (Color)-24V-L	DC 24V	4 W	329 lm	84.2 lm/W	Ra > 90	2,700K 3,000K 3,500K 4,000K	21° 40° 50°	0.24 lb	32~113°F

### Dimension

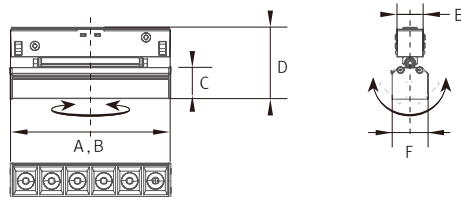

Model Name	A (mm)	B (mm)	C (mm)	D (mm)	E (mm)	F (mm)
FLT-LS15 30K-24V	98.6	98.6	19.1	43.8	16.2	21.8

Beam angle	Black	White
21°	FLT-LS10 30K-24V-BK-24	FLT-LS10 30K-24V-WT-24
40°	FLT-LS10 30K-24V-BK-36	FLT-LS10 30K-24V-WT-36
50°		

### Photometric data

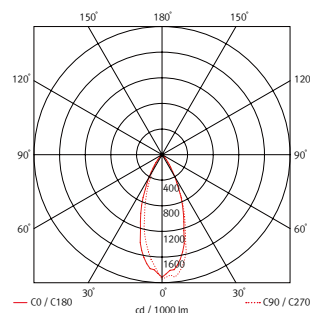

### Specification

Model Name	Power Input	Lamp Power	Lumens (3000K)	Efficiency (3000K)	Color Rendering	Available color	Beam Angle	Weight of Luminaire	Operating Temperature
FLT-LS30 (Color)-24V-L	DC 24V	11.5 W	1,049 lm	80 lm/W	Ra > 90	2,700K 3,000K 3,500K 4,000K	21° 40° 50°	0.4 lb	32~113°F

### Dimension

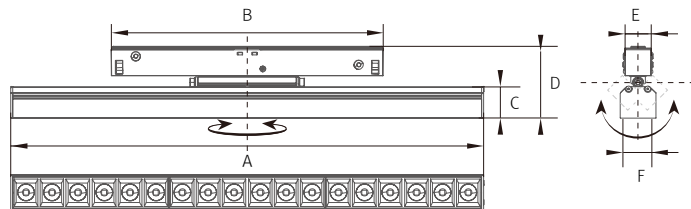

Model Name	A (mm)	B (mm)	C (mm)	D (mm)	E (mm)	F (mm)
FLT-LS30 30K-24V	303	167	20.5	43	16	20.5

Beam angle	Black	White
21°	FLT-LS30 30K-24V-BK-24	FLT-LS30 30K-24V-WT-24
40°	FLT-LS30 30K-24V-BK-36	FLT-LS30 30K-24V-WT-36
50°		

### Photometric data

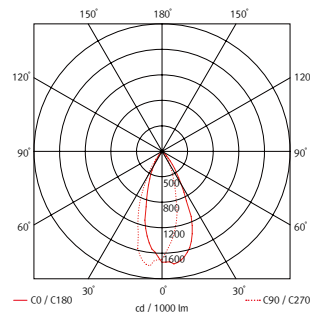

## FLT Track System - Pendant



### Specification

Model Name	Power Input	Lamp Power	Lumens (3000K)	Efficiency (3000K)	Color Rendering	Available color	Beam Angle	Operating Temperature
FLT-SP20 30K-24V	DC 24V	1.7 W	89 lm	53.2 lm/W	Ra > 90	2,700K/3,000K/3,500K/4,000K	15° / 24° / 36°	0 ~ 45°C

### Dimension

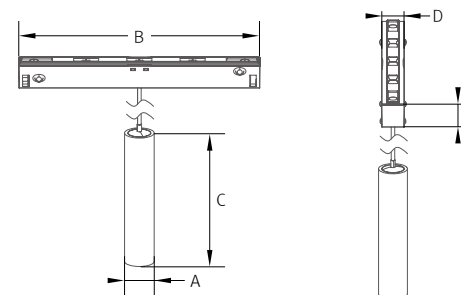

Model Name	A (mm)	B (mm)	C (mm)	D (mm)	E (mm)
FLT-SP20 30K-24V	20.5	167	200	16	18

Beam angle	Black	White
15°	FLT-SP20 30K-24V-BK-15	FLT-SP20 30K-24V-WT-15
24°	FLT-SP20 30K-24V-BK-24	FLT-SP20 30K-24V-WT-24
36°	FLT-SP20 30K-24V-BK-36	FLT-SP20 30K-24V-WT-36

### Photometric data

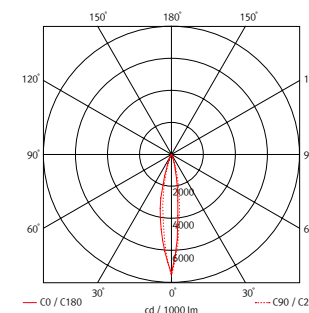

### Specification

Model Name	Power Input	Lamp Power	Lumens (3000K)	Efficiency (3000K)	Color Rendering	Available color	Beam Angle	Operating Temperature
FLT-SP30 30K-24V	DC 24V	2.8 W	81 lm	28.7 lm/W	Ra > 90	2,700K/3,000K/3,500K/4,000K	15° / 24° / 36°	0 ~ 45°C

### Dimension

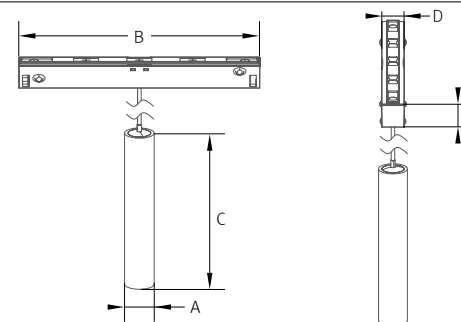

Model Name	A (mm)	B (mm)	C (mm)	D (mm)	E (mm)
FLT-SP30 30K-24V	20.5	167	300	16	18

Beam angle	Black	White
15°	FLT-SP30 30K-24V-BK-15	FLT-SP30 30K-24V-WT-15
24°	FLT-SP30 30K-24V-BK-24	FLT-SP30 30K-24V-WT-24
36°	FLT-SP30 30K-24V-BK-36	FLT-SP30 30K-24V-WT-36

### Photometric data

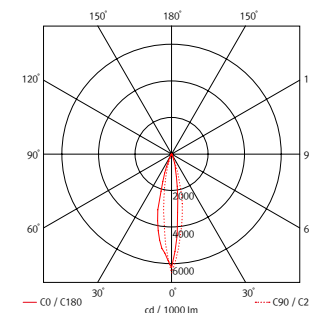

FLT Track

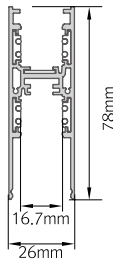
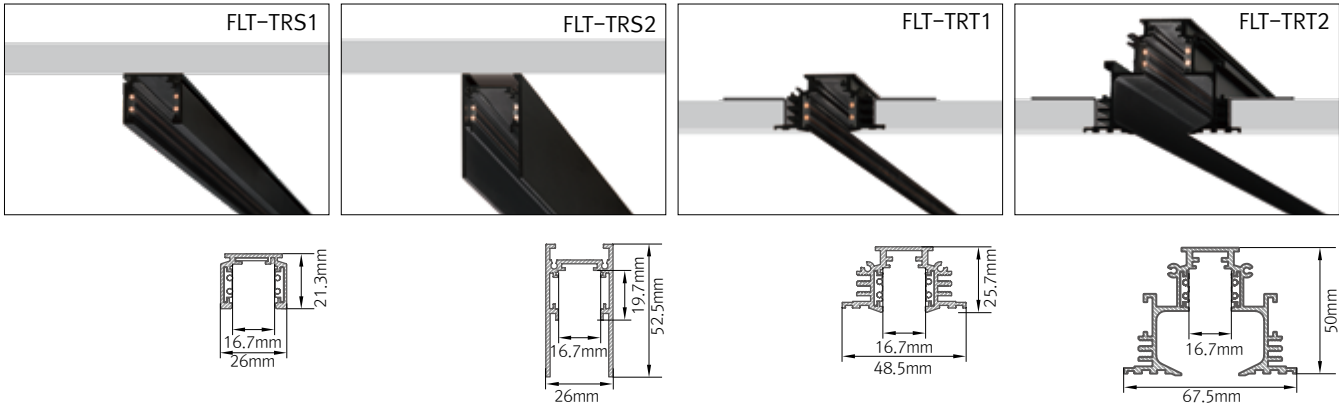

Compatible Luminaires					
Luminaire	FLT-TRS1	FLT-TRS2	FLT-TRT1	FLT-TRT2	FLT-TRH
FLT-SS06	○	○	○	○	○
FLT-SS06-Double joint	○	○	○	○	○
FLT-SS09 *	○	○	○	○	○
FLT-SS09-Double joint	○	○	○	○	○
FLT-SS15	○	○	○	○	○
FLT-SS15-Double joint	○	○	○	○	○
FLT-SS20	○	○	○	○	○
FLT-SS20-Double joint	○	○	○	○	○
FLT-SL06	○	○	○	○	○
FLT-SM02	○		○		
FLT-SM12	○		○		
FLT-LS15 *	○	○	○	○	○
FLT-LS30 *	○	○	○	○	○
FLT-LM30 *	○	○	○	○	○
FLT-SP20	○	○	○	○	○
FLT-SP30	○	○	○	○	○

\*Installation into the FLT-TRS2 track or the FLT-TRT2 track disables the ability to tilt and rotate the luminaire.

Installation

