

MonoRail2

Magnetic Lighting System for Display, Cove & Drywall

Display & Cove system for long runs!



- High-end slim linear LED with Spot-free illumination
- Mini Spotlight available with Dimming Touch Sensor
- Easy installation with Magnetic rail system
- Tunable White Color option available
- Various Aluminum Extrusion Profiles available

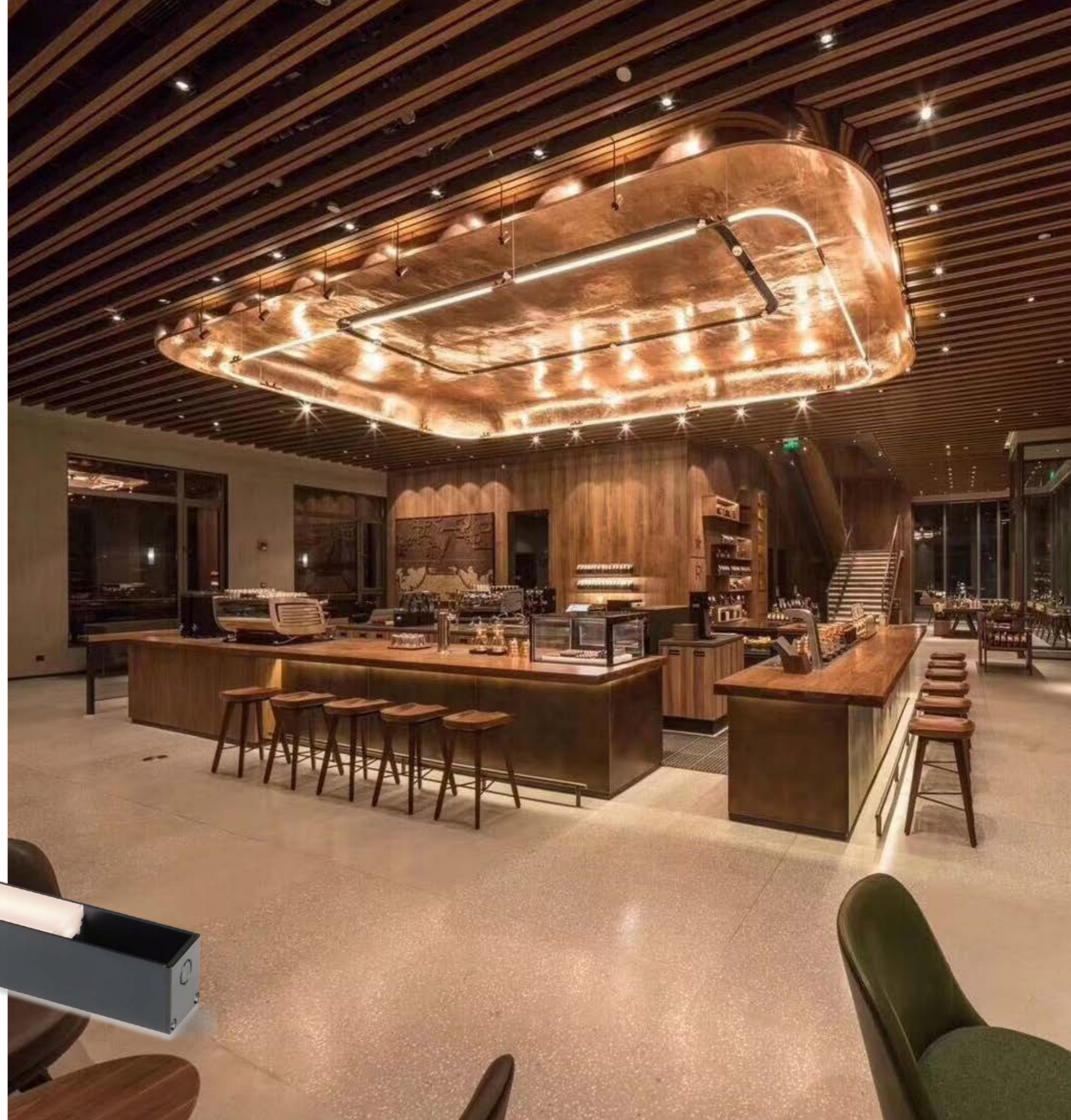



MonoRail 2
Display & Cove System for Long runs!



MonoRail2 3W Length (97mm)



* MonoRail2 4W Length (145mm)



* MonoRail2 8W Length (288mm)



NMP-Rail (power supply track)

* Only 4W/8W are available for the direct connection

Various options

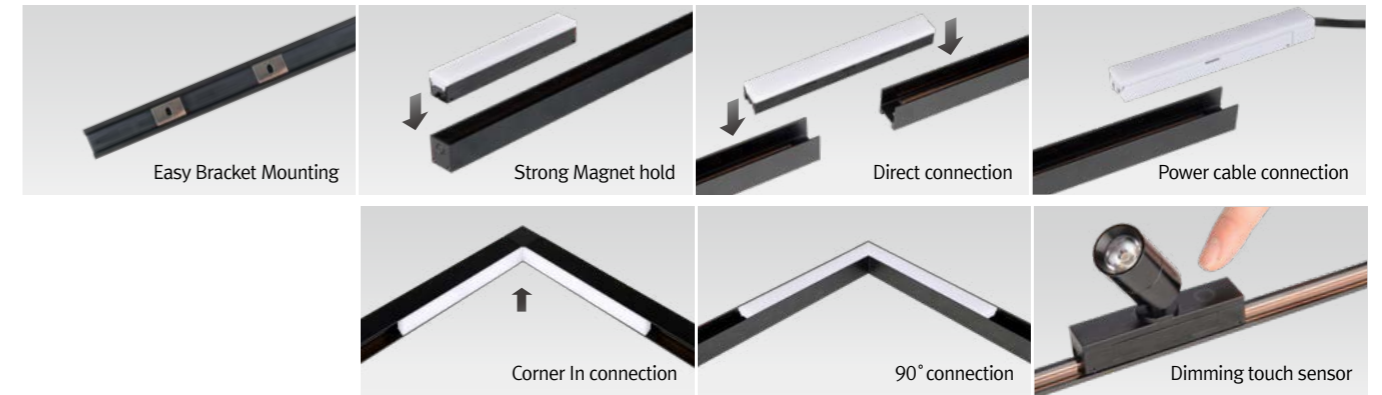

Extrusion Types



Installation

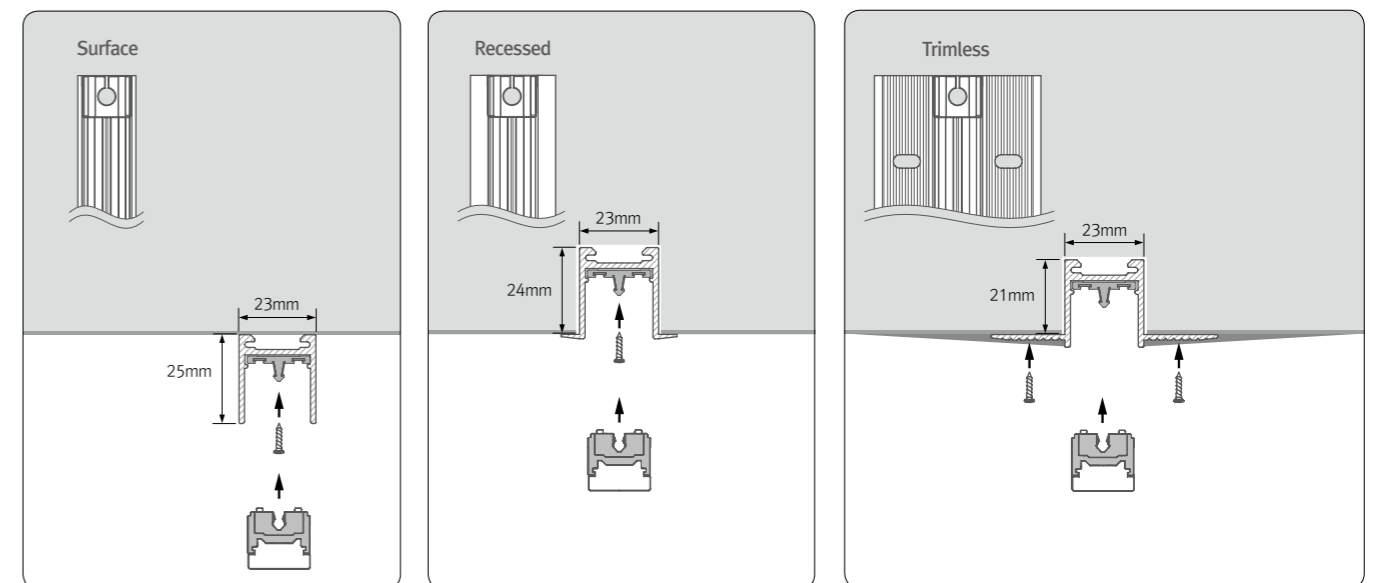

Max. connection

- MonoRail2 : 180W in one row (Single power feed)
- LED Driver

Model Name	Max. units for LED Driver		
	24V/30W	24V/75W	24V/200W
NMS3 40K-24V	11	28	76
NMP3 40K-24V-C90	12	30	80
NMP4 40K-24V-C90	7	19	52
NMP8 40K-24V-C90	4	10	26

Specification

Model Name	Power Input	Lamp Power	Luminous Flux	Efficiency	Color Rendering	Available Color	Operating Temperature
NMS3 40K-24V	DC24V	2.6W	220	90lm/W	Ra>80	2,200K/2,500K/2,700K/3,000K/3,500K/4,000K/5,000K	0-45°C
NMS3 40K-24V-T	DC24V	2.6W	220	90lm/W	Ra>80	2,200K/2,500K/2,700K/3,000K/3,500K/4,000K/5,000K	0-45°C
NMP3 40K-24V-C90	DC24V	2.5W	190	80lm/W	Ra>90	2,200K/2,500K/2,700K/3,000K/3,500K/4,000K/5,700K	0-45°C
NMP4 40K-24V-C90	DC24V	3.8W	300	80lm/W	Ra>90	2,200K/2,500K/2,700K/3,000K/3,500K/4,000K/5,700K	0-45°C
NMP8 40K-24V-C90	DC24V	7.5W	510	70lm/W	Ra>90	2,200K/2,500K/2,700K/3,000K/3,500K/4,000K/5,700K	0-45°C

Dimension

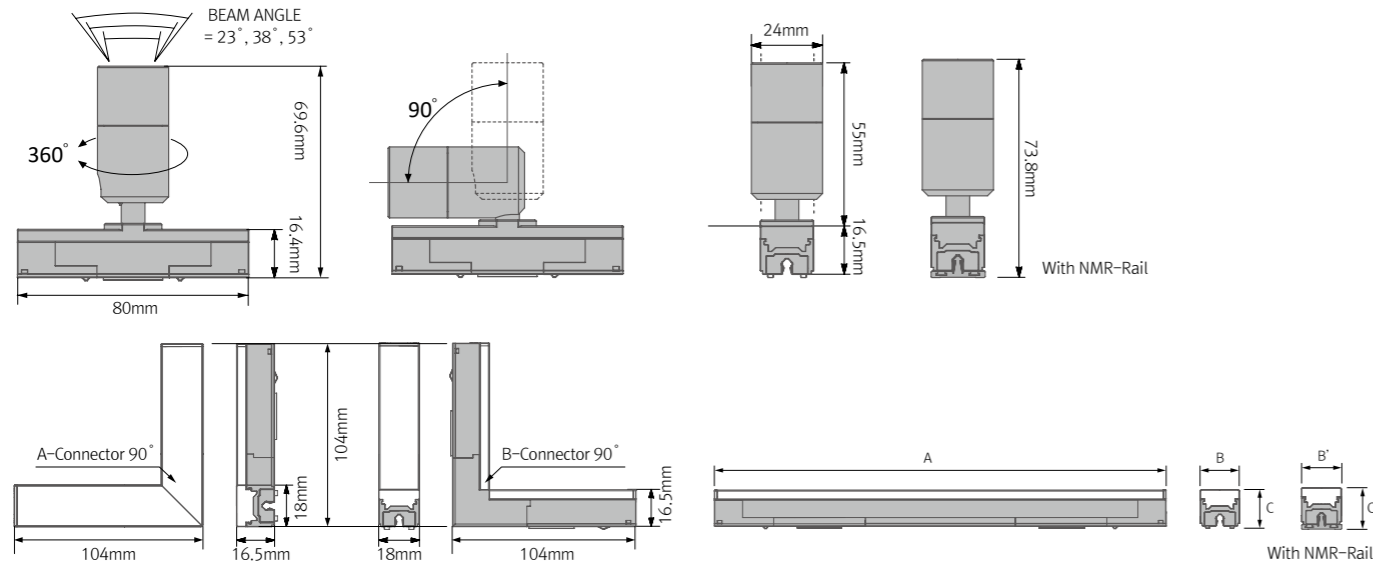

Model Name	Power Input (V)	Lamp Power (W)	A (mm)	B (mm)	B' (mm)	C (mm)	C' (mm)
NMP3 40K-24V-C90	DC 24	2.5W	95	18	18	16.5	18.8
NMP4 40K-24V-C90	DC 24	3.8W	145	18	18	16.5	18.8
NMP8 40K-24V-C90	DC 24	7.5W	286	18	18	16.5	18.8

Model Name	A (mm)	B (mm)	C (mm)
FLC30-24V/T	150	41	31
FLC75-24V-P/T	180	60	32

* LED Driver

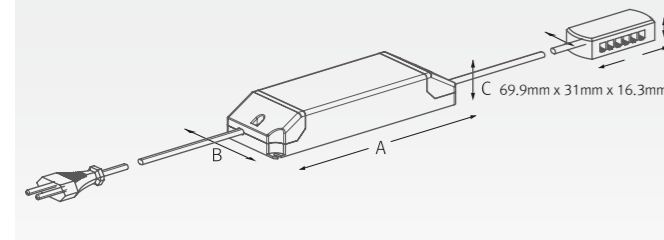

Model Name	A (mm)	B (mm)	C (mm)
FLC200-24V/T	228	68	39

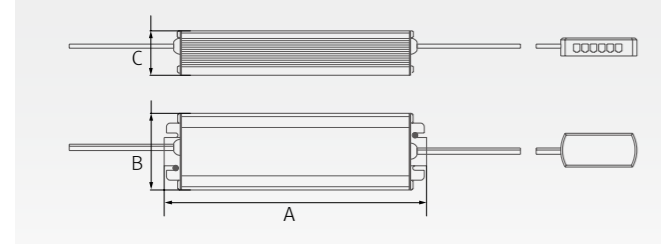

* Power Cable

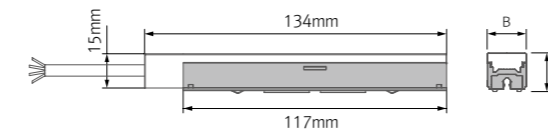

* NMR-Rail Surface extrusion

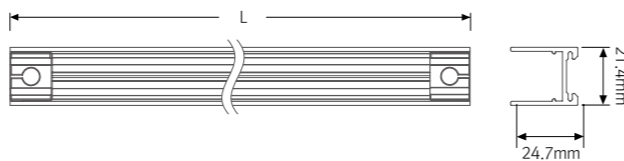

* NMR-Rail Recessed extrusion

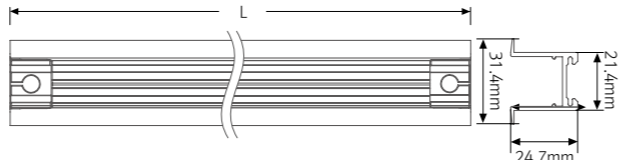

* NMR-Rail Trimless extrusion

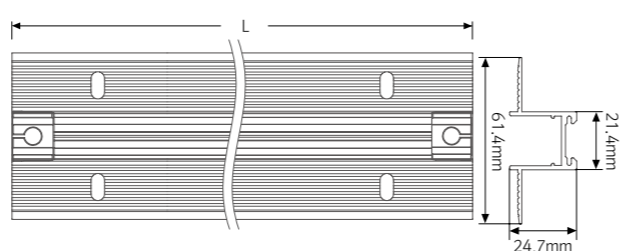

Accessories

Ⓐ MonoRail2 Spot

Beam angle	Black	White
23°	NMS3 40K-24V-BK-23	NMS3 40K-24V-WT-23
38°	NMS3 40K-24V-BK-38	NMS3 40K-24V-WT-38
53°	NMS3 40K-24V-BK-53	NMS3 40K-24V-WT-53

* Available Color : Black, White

Ⓑ MonoRail2 Spot (Touch Sensor)

Beam angle	Black	White
23°	NMS3 40K-24V-BK-23-T	NMS3 40K-24V-WT-23-T
38°	NMS3 40K-24V-BK-38-T	NMS3 40K-24V-WT-38-T
53°	NMS3 40K-24V-BK-53-T	NMS3 40K-24V-WT-53-T

* Available Color : Black, White

Ⓒ Vertical LED Power Cable : NMP3 40K-24V-C90-L134P

Monorail2 3W fixture (134mm) DC 24V Vertical Power Connection with Extrusion - 1ch/2ch

Ⓓ LED Vertical In Connector : NMP5 40K-24V-C90-C

Monorail2 Corner in Connector 5W DC24V

Ⓔ LED Vertical 90° Connector : NMP5 40K-24V-C90-90

Monorail2 90° Connector 5W DC 24V

Ⓘ Vertical Power Cable : NMPPC-VE

Monorail2 Vertical Power Connection - 1ch/2ch

Ⓙ Vertical Direct Connector : NMPCPL-VE

Ⓚ Vertical In Connector : NMPCPL-CI

Ⓛ Vertical 90° Connector : NMPCPL-90

Ⓜ NMR-Rail Extrusion Surface (600mm/900mm/1,200mm)

Black	White
NMP-EXS-BK	NMP-EXS-WT

*With NMR-Rail

Ⓨ NMR-Rail Extrusion Recess (600mm/900mm/1,200mm)

Black	White
NMP-EXR-BK	NMP-EXR-WT

*With NMR-Rail

Ⓩ NMR-Rail Extrusion Trimless (600mm/900mm/1,200mm)

Black	White
NMP-EXT-BK	NMP-EXT-WT

*With NMR-Rail

ⓐ Standard mounting bracket : NMP-BRACKET1

NMP-BRACKET1 : 1 set = 2pcs

Accessories for MonoRail2 Pendant

ⓑ Horizontal connection for pendant : NMPPC-HE

Ⓒ Horizontal long interconnection for pendant : NMPPTC-HE

Ⓓ Horizontal Horizontal interconnection for pendant : NMPCPL-HE

Ⓔ L figure Horizontal interconnection for pendant : NMPCPL-HE-L

Ⓛ LED Driver with 12way distributor, with power cord (1,800mm)

Part NO	FLC30-24V/T	FLC75-24V-P/T
Capacity	24V/30W	24V/75W

Ⓜ LED Driver : FLC200-24V/T (200W, DC24V)

LED Driver With 12way distributor

