

## PRODUCT FEATURES

- Ultra Slim Profile
- Quick connection system between fixtures
- Multiple lengths options available
- Various mounting methods including magnetic
- Constant voltage DC 24V driver
- Dimmable

## PRODUCT SPECIFICATIONS

Power Input	24VDC Constant Voltage Feelux or Class 2 Drivers
Color Rendering Index	Ra>85
Available CCTs	2700K, 3000K, 3500K, 4000K, 6000K
Energy Efficiency	LED 100 lm/W, Luminaire 65lm/W
Operating Temperature Ranges	32-113°F (0-45°C)
Dimming with Feelux Interface	PWM/0-10V/DALI/PHASE/DMX512/WIRELESS
Material	Aluminum
Beam Angle	95° / Round and Square Lens - 220°
Lamp Life	50,000hr / 70%
Warranty	3 year
Product is approved for Closet / Storage space installation per NEC410.16 (A) (3) and NEC410.16 (C)(5) per NRTL certification	

## DIMENSIONS

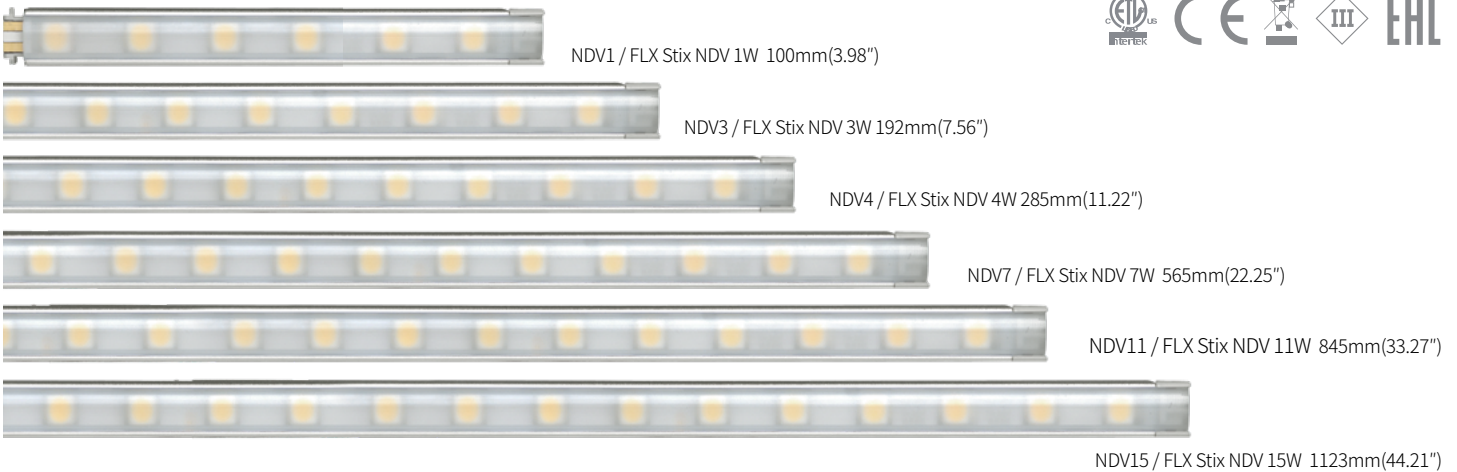

Model Number	Voltage Input (V)	Power Input (W)	Luminous Flux (lm) / 4000K	A mm (inches)	B mm (inches)	C mm (inches)
NDV1-(Color)K-24V	DC 24	1.28	99	95 (3.74")	100 (3.93")	117 (4.6")
NDV3-(Color)K-24V	DC 24	2.51	203.1	188 (7.4")	192 (7.5")	210 (8.26")
NDV4-(Color)K-24V	DC 24	3.71	306.4	280 (11")	285 (11.2")	302 (11.8")
NDV7-(Color)K-24V	DC 24	7.6	563.1	560 (22")	565 (22.2")	582 (22.9")
NDV11-(Color)K-24V	DC 24	11.22	912.2	840 (33")	845 (33.2")	862 (33.9")
NDV15-(Color)K-24V	DC 24	14.15	1147.9	1118 (44")	1123 (44.2")	1140 (44.9")

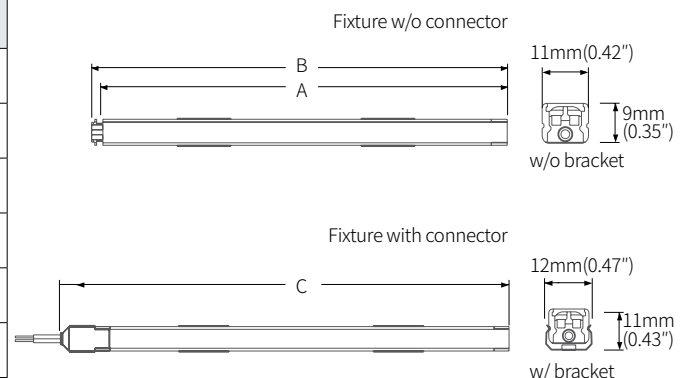

## EASY CONNECTION

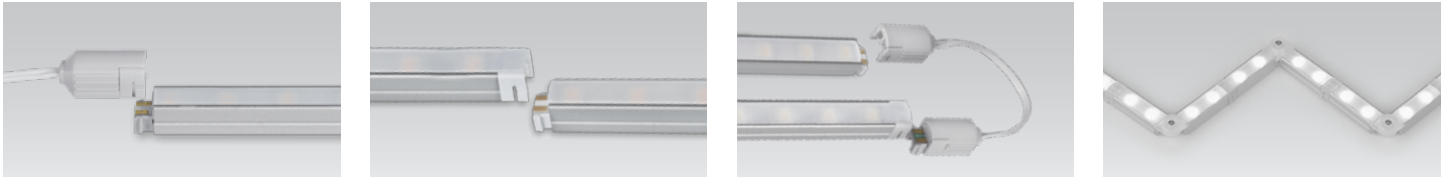

## OPTIONS



Inline Dimmer

## INSTALLATION

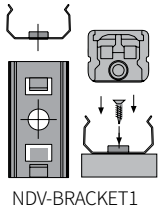

NDV-BRACKET1

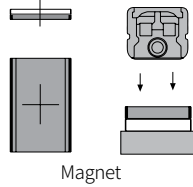

Magnet

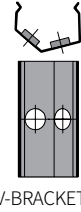

NDV-BRACKET2

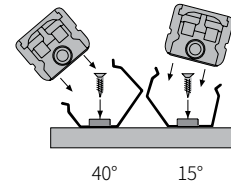

40° 15°

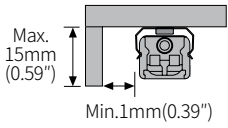

Min.1mm(0.39")

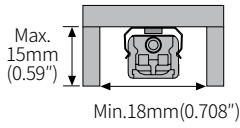

Min.18mm(0.708")

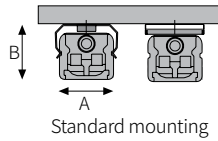

Standard mounting

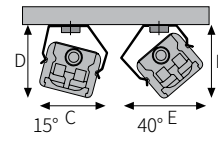

15° C 40° E

## INLINE DIMMER



Inline Dimmer

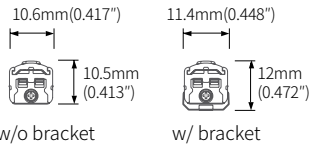
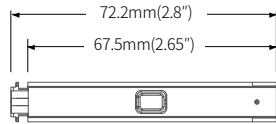

w/o bracket

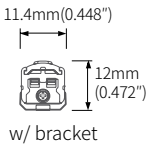

w/ bracket

## DIMENSION

\*Flexible Connector

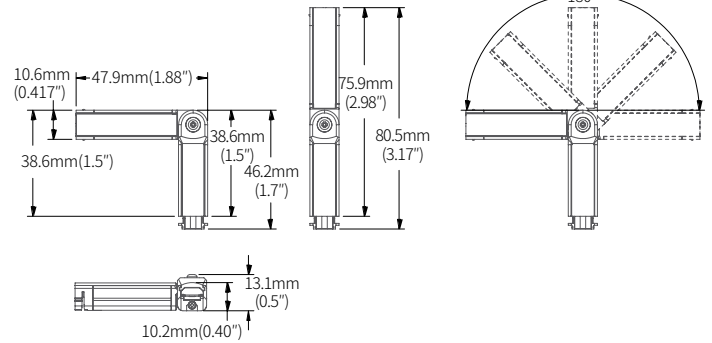

## LED DRIVER OPTIONS

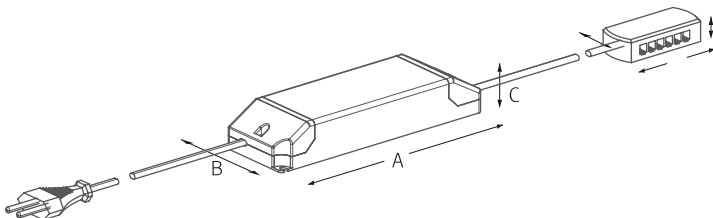

Model Number	A mm (inches)	B mm (inches)	C mm (inches)
FLC30-24V/T	150 (5.9")	41 (1.6")	31 (1.22")
FLC75-24V/T	180 (7.08")	60 (2.36")	32 (1.25")

## CONNECTION

**NO RUN TO EXCEED 55W**

IF LONGER RUNS ARE REQUIRED USE SIDE FEED UNIT NDV3-(COLOR)K-24V-S TO CONTINUE SEAMLESS LIGHTING.  
NOT TO EXCEED 90% OF DRIVER RATED WATTAGE.

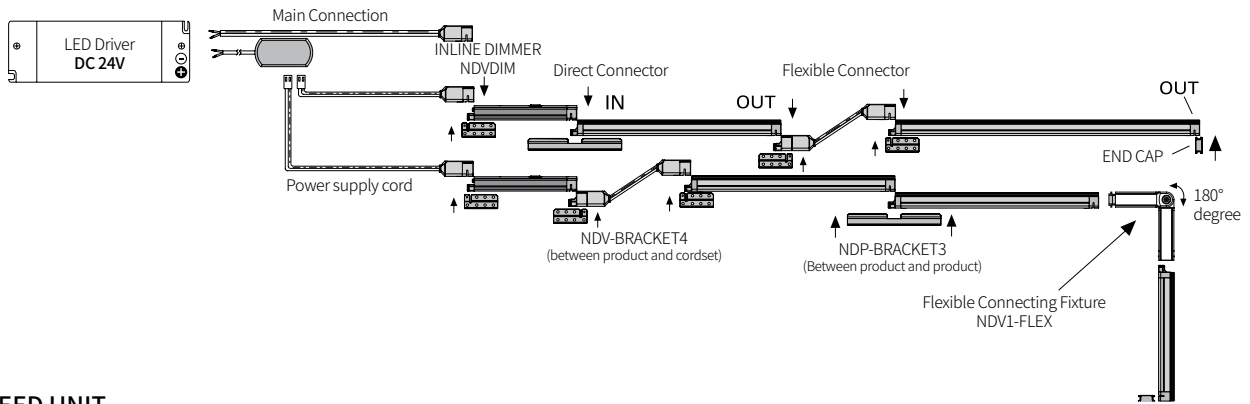

## SIDE FEED UNIT

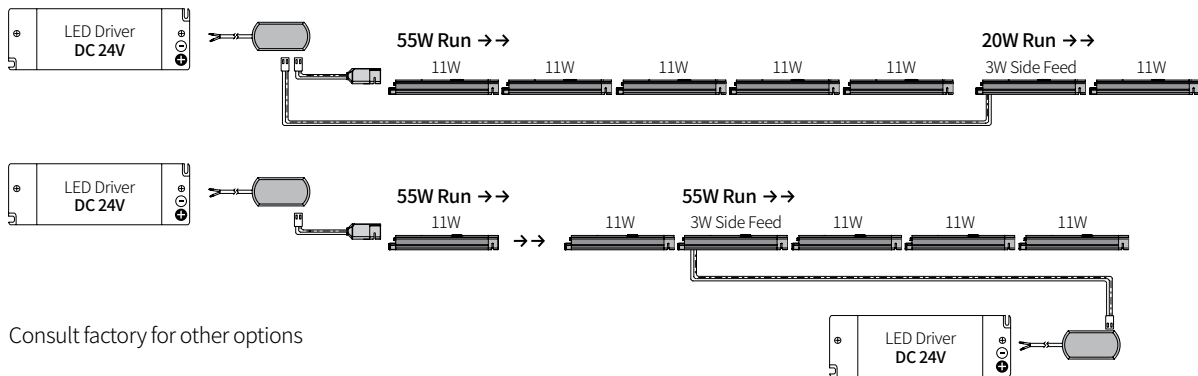

Consult factory for other options

CAN POWER UP TO 55 WATT MAX FIXTURE LOAD. CONNECTED LINE OF LIGHT REQUIRES SIDE FEED EVERY 15FT(55WATT). TOTAL CONNECTED LOAD SHOULD NOT EXCEED 90% OF DRIVER WATTS

## BEAM SPREADS

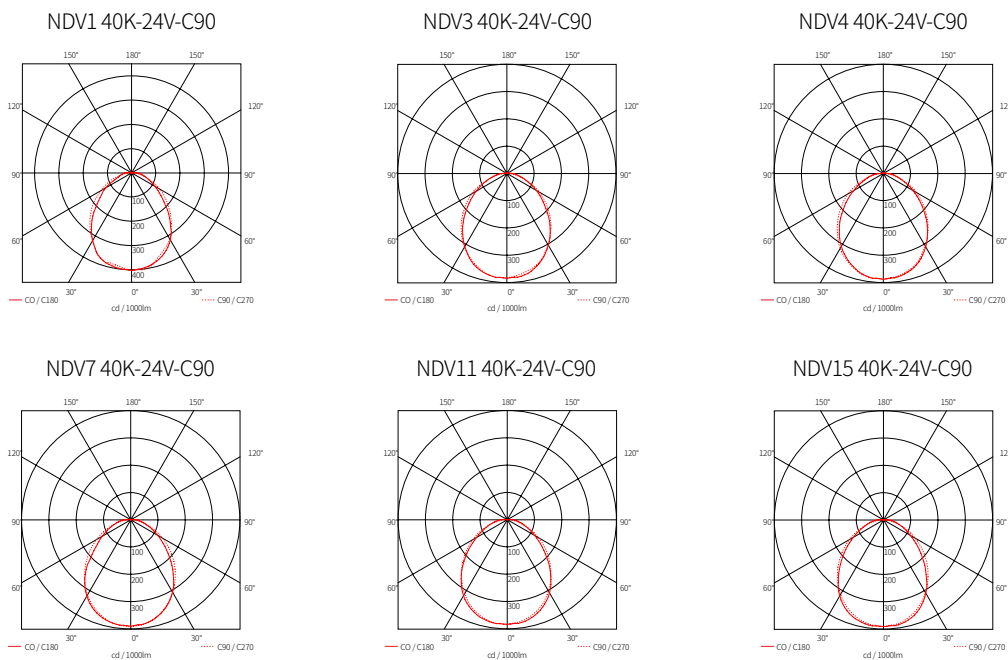

## COMPONENTS

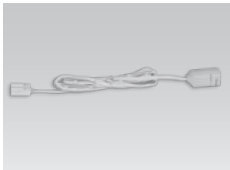

### Power Cable

- \_\_NDVPC (2,500mm)
- \_\_NDVPC (4,000mm)

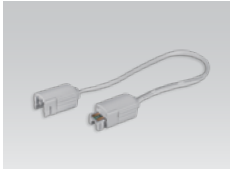

### Connecting Cable

- \_\_NDVPTC (2,500mm)
- \_\_NDVPTC1 (300mm)
- \_\_NDVPTC2 (600mm)
- \_\_NDVPTC4 (1,200mm)
- \_\_NDVPTC6 (1,800mm)

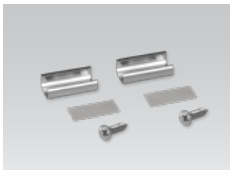

### Metal Mounting Brackets

- \_\_NDV-BRACKET1
- Included with fixture



### Angled Brackets

- \_\_NDV-BRACKET2
- Angled 15°/40° (BK2)  
Optional



### Connecting Brackets

- \_\_NDV-BRACKET3
- Fixture to Fixture  
Included with fixture



### Power Brackets

- \_\_NDV-BRACKET4
- Included with NDPPC  
and NDPPTC



### Sidefeed for Seamless Extension (3W)

- \_\_NDV3-(color)K-24V-S



### Flexible Connector

- \_\_NDV1-(color)K-24V-FLEX



### End Cap

- \_\_NDV-CAP
- Included with fixture

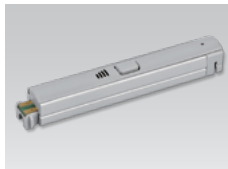

### In-Line Dimmer

- \_\_NDVDIM
- (Max 55W in a row)

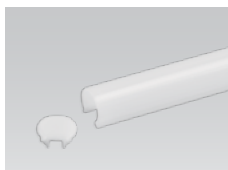

### Round Diffuser

- \_\_NDV1VRM (1W)
- \_\_NDV3VRM (3W)
- \_\_NDV4VRM (4W)
- \_\_NDV7VRM (7W)
- \_\_NDV11VRM (11W)
- \_\_NDV15VRM (15W)



### Square Diffuser

- \_\_NDV1VSM (1W)
- \_\_NDV3VSM (3W)
- \_\_NDV4VSM (4W)
- \_\_NDV7VSM (7W)
- \_\_NDV11VSM (11W)
- \_\_NDV15VSM (15W)

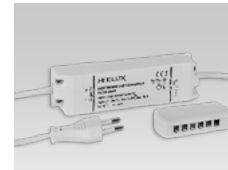

### LED Drivers

- \_\_FLC30-24V/T (30W)
  - \_\_FLC75-24V/T (75W)
- with distributor and power cord (1,800mm)



### LED Driver

- \_\_FLC200-24V/T (200W)
- with 12way distributor



### Dimming Interface

- \_\_FDA-L2MO
- (0-10V/1-10V, DMX512)  
Max. 200W (100W/CH, 2CH)
  - \_\_FDA-L5M (DMX512)

Max. 200W (50W/CH, 5CH)



### Door and motion sensor

- \_\_FLS-M24V



### Occupancy sensor

- \_\_FLS-P24V