

DATE

PROJECT

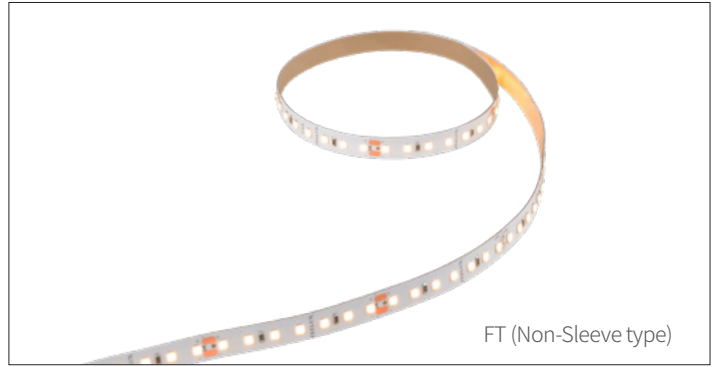

## PRODUCT FEATURES

- Various wattage option available
- Easy installation with adhesive tape
- Field cuttable for customized length
- Flexible strip covered with soft silicon sleeve
- Constant voltage DC24V driver
- RGBWW version available (Dimmable)
- \* Without silicon sleeve type (Optional)

## PRODUCT SPECIFICATIONS

IP Rate	IP66 with Factory Termination (Sleeve type) IP20 with Factory Termination (Non-Sleeve type)
Lamp Power	5, 8, 10, 15W/m
Power Input	24V DC
Color Rendering	Ra>90
Operating Temperature Ranges	0-45°C (32-113°F)
Beam Angle	110°
Cutttable	50mm (1.97")
Material	Silicon
Available Color	2200K, 2400K, 2700K, 3000K, 3500K, 4000K, 5000K, RGBW

## SPECIFICATIONS TABLE

Model Number	Lamp Power	Luminous Flux (lm/m)	Lumen/W	Note
FT5 (Color)K-24V	4.5 W/m	480 lm	107 lm/W	Non-Sleeve Type
FT8 (Color)K-24V	7.5 W/m	730 lm	104 lm/W	
FT10 (Color)K-24V	9.5 W/m	1,010 lm	101 lm/W	
FT15 (Color)K-24V	15 W/m	1,515 lm	101 lm/W	
FTS5 (Color)K-24V	4.5 W/m	520 lm	116 lm/W	Sleeve Type
FTS8 (Color)K-24V	7.5 W/m	790 lm	113 lm/W	
FTS10 (Color)K-24V	9.5 W/m	1,100 lm	110 lm/W	
FTS15 (Color)K-24V	15 W/m	1,650 lm	110 lm/W	

## PHYSICAL SPECIFICATIONS

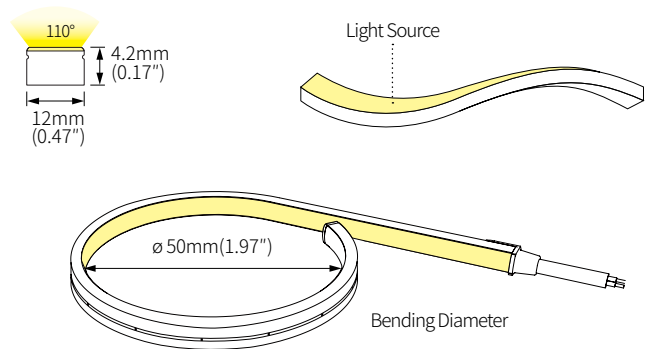

## DIMENSIONS

TOP VIEW

\*Silicon sleeve type (FTS5, FTS8, FTS10, FTS15)

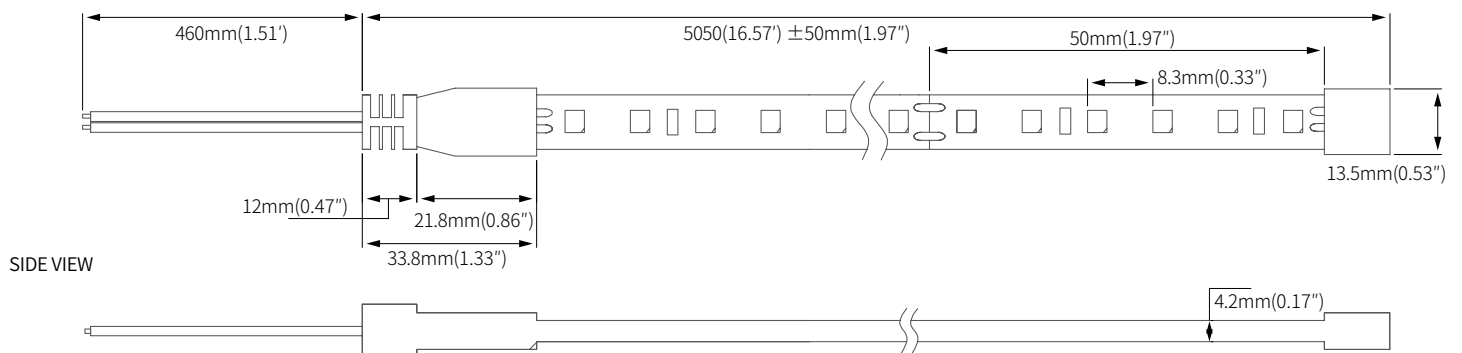

## INSTALLATION

### 1. Bracket Installation

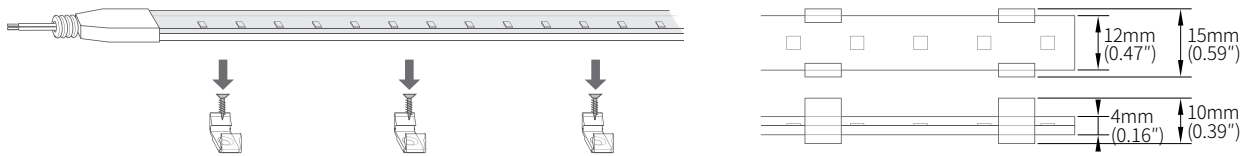

### 2. 3M Glue Installation

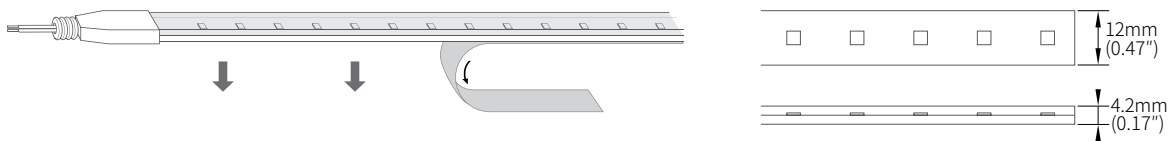

### 3. FTP-EXL Installation

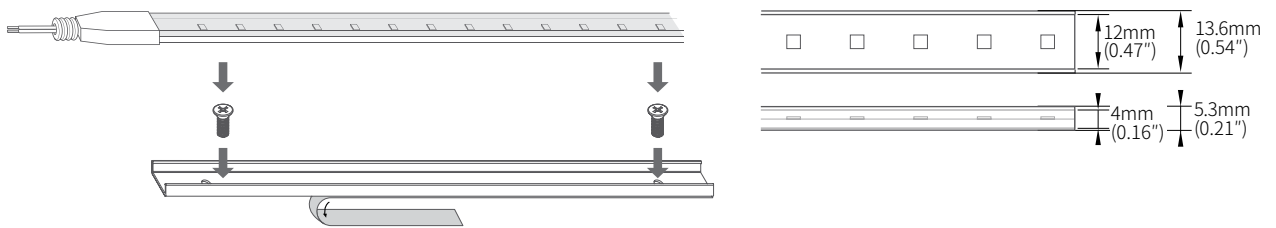

### 4. Installation of end cap

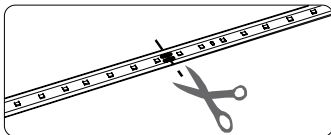

1. Cut the tape along the dotted line with scissors.

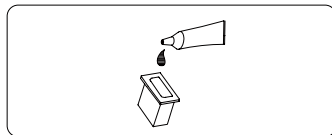

2. Drip appropriate amount of glue about 1/4 depth of the groove into the waterproof plug.

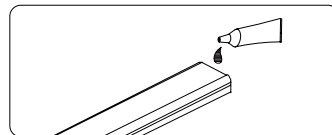

3. Drip a circle of glue over one end of the LED.

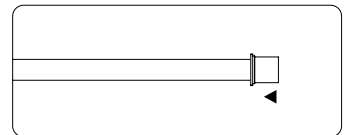

4. Insert LED end into end cap till to hole bottom, then clean exceeded glue. Only after 20 hours of glue solidification.

### 5. Installation of power cable connector

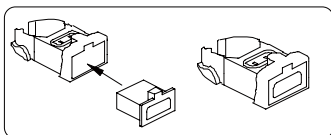

1. Insert the silicon-cap to the groove of bottom cover. Squeeze tightly and make sure the cap is compacted, flat and level with the bottom cover.

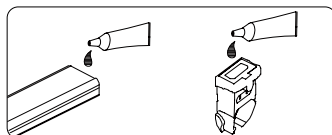

2. Drip moderate amount of glue into the installed waterproof plug and the end of LED. (Please check the connection of the polarity is right.)

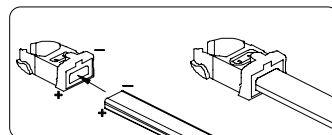

3. Insert LED into silicon connector. Keep LED positive and negative connecting points in line with bottom hole.

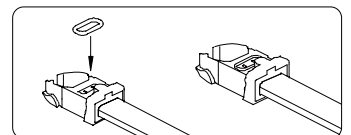

4. Put silicon waterproof ring onto recessed groove. Squeeze firmly.

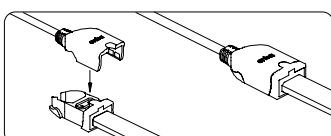

5. Keep top part inline with bottom part hole. Press top hard onto bottom and compact together. ensure both edges of top and bottom part are inline.

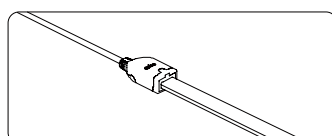

6. Do power-on test, and clean the spilled glue on the surface of the LED.

## 6. Installation of interconnector

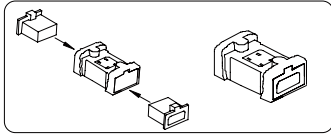

1. Insert silicon-caps into connector both ends. Press firmly, ensure both ends in same level.

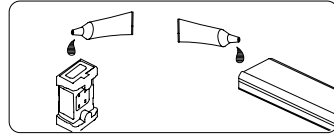

2. Drip moderate amount of glue into the installed waterproof plug and the end of LED. (Please check the connection of the polarity is right.)

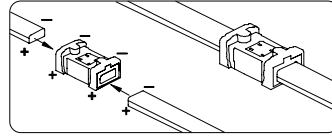

3. Insert LED into end caps bottom. Keep LED positive and negative connecting points in line with bottom hole.

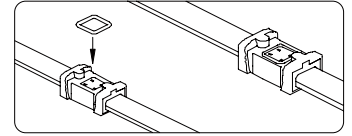

4. Put silicon waterproof ring onto recessed groove. Squeeze firmly.

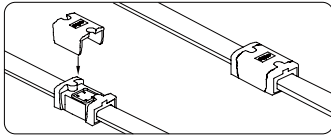

5. Pin the cover to the base, press hard and compact them together. Squeeze tightly to make them well compacted together, with edges on a horizontal line.

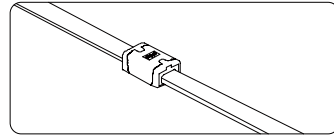

6. Do power-on test, and clean the spilled glue on the surface of the LED.

## COMPONENTS



### Flexible Tape (Sleeve type)

- \_\_FTS5 (color)K-24V [5M]
- \_\_FTS8 (color)K-24V [5M]
- \_\_FTS10 (color)K-24V [5M]
- \_\_FTS15 (color)K-24V [5M]

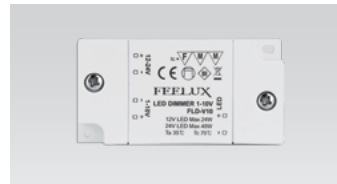

### Dimming Interface

- \_\_FDC-L10
- Max. 100W (100W/CH, 1CH) 0-10V Signal



### Flexible Tape (Without Sleeve type)

- \_\_FT5 (color)K-24V [5M]
- \_\_FT8 (color)K-24V [5M]
- \_\_FT10 (color)K-24V [5M]
- \_\_FT15 (color)K-24V [5M]



### Dimming Interface

- \_\_FDA-L2MO
- (0-10V/1-10V, DMX512)
- Max. 200W (100W/CH, 2CH)
- \_\_FDA-L5M (DMX512)
- Max. 200W (50W/CH, 5CH)



### Power cord for sleeve type

- \_\_FTSPC (500mm/1.64')



### Dimming Interface (Dail)

- \_\_FDD-L1DA
- Max. 200W (100W/CH, 1CH)



### Direct connector for sleeve type

- \_\_FTSCPL



### Dimming Interface

- \_\_FDD-L20
- (0-10V/1-10V)

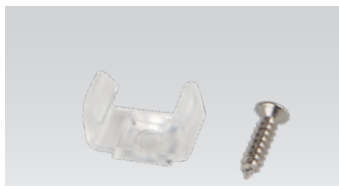

### Mounting brackets

- \_\_FTS-BRACKET



### LED Drivers

- \_\_FLC30-24V/T (30W)
- \_\_FLC75-24V/T (75W)
- With distributor and power cord 1800mm (6')



### FTP Extrusion Line

- \_\_FTP-EXL (1200mm/3.94')



### LED Driver

- \_\_FLC200-24V/T (200W)
- with 12way distributor