

PRODUCT IMAGE

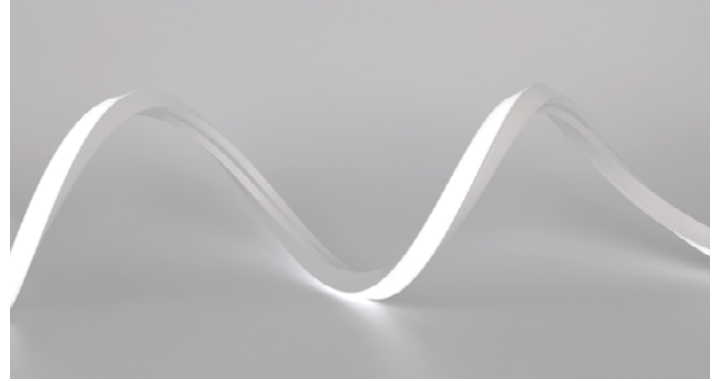
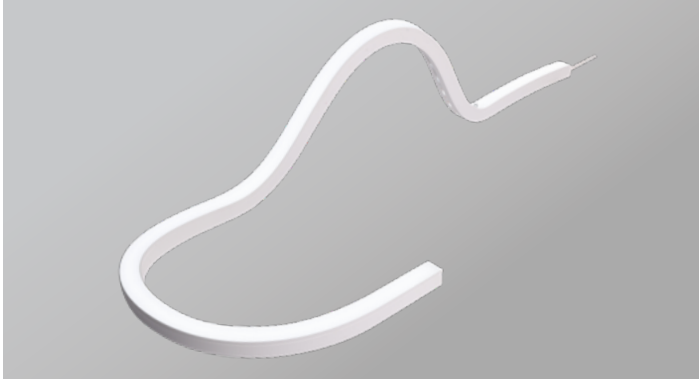

PRODUCT FEATURES

- Seamless Spot Free Illumination
- Bend Direction Horizontally and Vertically
- Indoor and Outdoor Application
- Field Cuttable 20.83mm (0.82")
- Available in Standard Lengths 5M Reels
- Architectural contour lighting
- Dimmable

PRODUCT SPECIFICATIONS

IP Rate	IP67
Maximum Length	5M(16.4')
Power Input	24V DC
Watt per meter	14.4W/m(4.39W/ft)
Dimension	15x15mm (0.59" x 0.59")
Cuttable	20.83mm (0.82")
Minimum bend Diameter	150mm (5.91")
Material	Silicon
Operating Temperature Ranges	-20°C to 45°C (-4°F~113°F)
Beam Angle	120°

SPECIFICATIONS TABLE

Model Number	Power Input	Lamp Power	Luminous Flux (lm/W)	Lumen/W
FN3D 22K-24V	DC 24V	14.4W/m (4.39W/ft)	936 lm/W	65 lm/W
FN3D 24K-24V			936 lm/W	65 lm/W
FN3D 27K-24V			936 lm/W	65 lm/W
FN3D 30K-24V			936 lm/W	65 lm/W
FN3D 35K-24V			1,008 lm/W	70 lm/W
FN3D 40K-24V			1,008 lm/W	70 lm/W

PHYSICAL SPECIFICATIONS

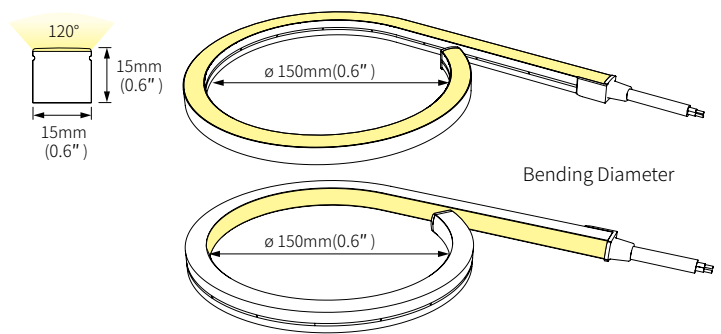

DIMENSIONS

TOP VIEW

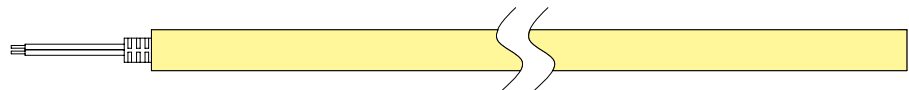

SIDE VIEW

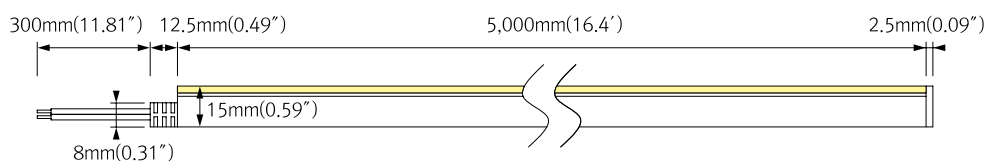

BOTTOM VIEW

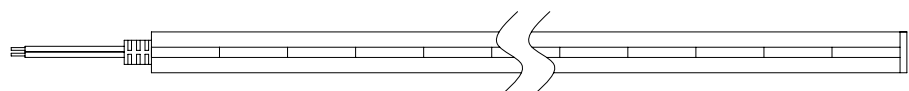

Installation

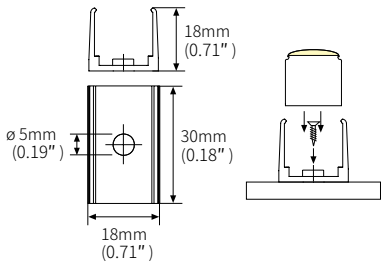

* Bracket Installation per 25cm is recommended
(4 pcs of brackets are provided per meter)
Additional Brackets can be used, if necessary

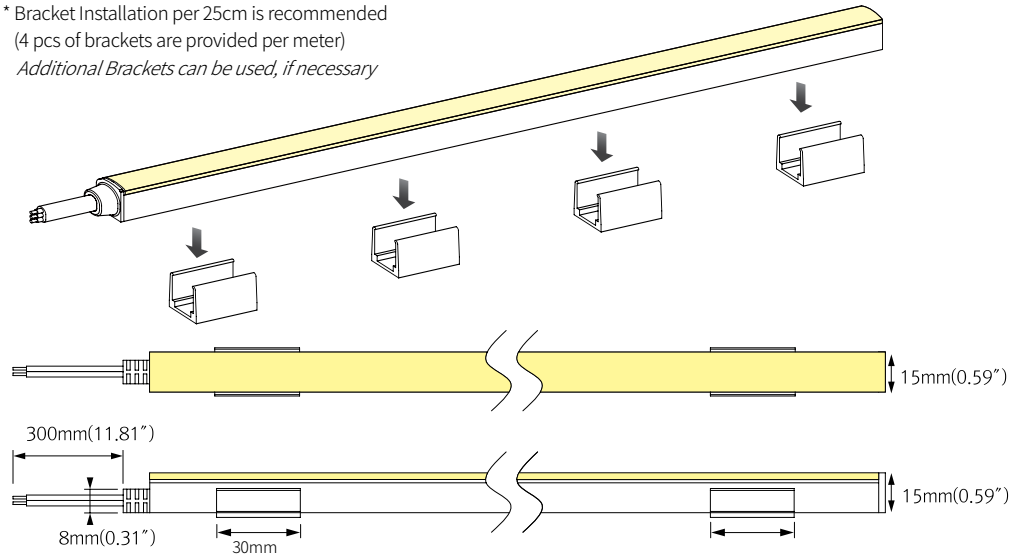

BEAM SPREADS

FN3D 30K-24V
65lm/W
285lm

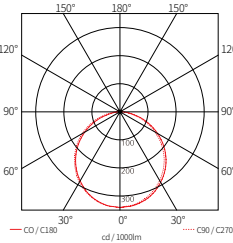

FN3D 57K-24V
65lm/W
305lm

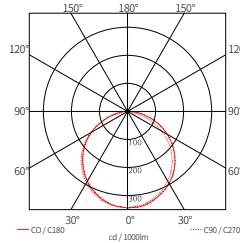

COMPONENTS

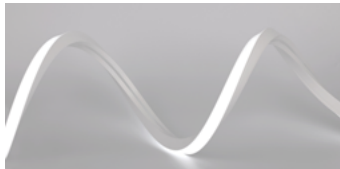

FLXible Neon 3D

- __FN3D-(color)K-24V-C90 (1M)
- __FN3D-(color)K-24V-C90 (2M)
- __FN3D-(color)K-24V-C90 (3M)
- __FN3D-(color)K-24V-C90 (4M)
- __FN3D-(color)K-24V-C90 (5M)



FN3D Mounting Brackets

- __FN3D-BRACKET1 (1set = 4pcs)



FN3D Extrusion Line

- __FN3D-EXL (1m)



FN3D End Cap

- __FN3D-END CAP

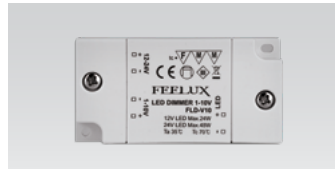

Dimming Interface

- __FDC-L10
- Max. 100W (100W/CH, 1CH) 0-10V Signal



Dimming Interface

- __FDA-L2MO
- (0-10V/1-10V, DMX512)
- Max. 200W (100W/CH, 2CH)
- __FDA-L5M (DMX512)
- Max. 200W (50W/CH, 5CH)



Dimming Interface (Dail)

- __FDD-L1DA
- Max. 200W (100W/CH, 1CH)



LED Drivers

- __FLC30-24V/T (30W)
- __FLC75-24V/T (75W)
- With distributor and power cord
- 1800mm (6')



LED Driver

- __FLC200-24V/T (200W)
- with 12way distributor

A Larger selection of drivers are available including remote and hard wire drivers. Please consult factory.